

# 3D Presentations

JNE generates 3D presentations to illustrate structures, processes and equipment for our clients. These presentations are an outstanding way to visualize the new facility before construction.

The presentations are modeled in 3D from 2D AutoCAD drawings and linked to Autodesk Viz. In Viz, the lighting, textures and cameras are added to produce a full motion video presentation.

## API Manufacturer

JNE designed a new facility for this client for the manufacture of active pharmaceutical ingredients. The video was developed to walk the client through the new facility, and give an idea of the space being created.



## New Steam Technologies

A video was developed to exhibit one of the products manufactured by the company called a Once Through Steam Generator (OTSG). The video displayed the steel framing, casing, platforms and stair towers used to access the sample ports for exhaust testing and maintenance.



## Hydrogen Bell Anneal Furnace

A series of videos were developed to test the sight lines from the pulpit of the overhead crane to the farthest row of the new hydrogen bell anneal furnaces. There was some concern from the steel maker that the crane operator would not be able to see the farthest row of furnaces when loading and unloading. Four videos were developed to test the sightlines and verify that loading could be accomplished successfully for each position.



*continued on back page*

# 3D Presentations

*(continued)*

## **Contract Pharmaceutical Manufacturer**

JNE provided the design of new change rooms and GMP compliant offices to facilitate the expansion of the product lines at this facility. Some of the new corridors



allowed the non-GMP compliant office personnel to bypass the GMP compliant corridors on their way to other office areas in the facility. The video was developed to illustrate this non-GMP personnel route and show the client how the corridor would appear after construction.

## **Acid Regeneration Process**

This structure was designed and constructed to house the acid regeneration process (ARP) equipment that recycles pickle liquor from a local steelmakers pickle line. The video was developed to illustrate the structure and the process equipment inside.

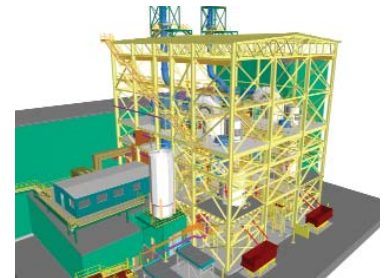

## **Ammonia Destruction Plant**

This structure was designed and constructed to house a flushing liquor ammonia destruction (FLAD) plant. The video was developed to illustrate the structure and the process equipment inside.

